

Cochran County UNUMS

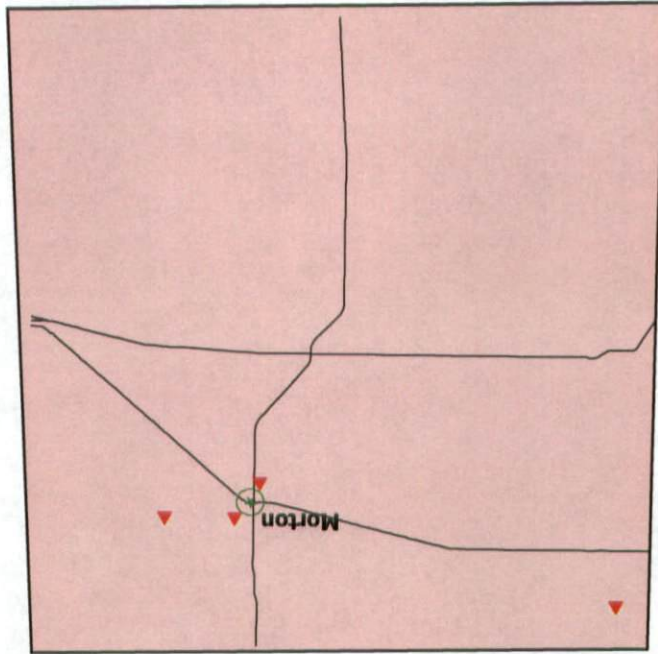

Four UNUM Sites
U-722
U-1869/32305
U-1870/31615
U-1871/31614

Closed Landfill Inventory UNUM Site

COG Name	South Plains Association of Governements
COG Number	2
County Name	Cochran
County Number	40
UNUM Number	722
Inspection Number	
Include?	Yes
Shape File	Yes
Location Confidence	No Confidence
Size	15
Comments	3 miles NW of FM 1780 - Hwy 116 intersection on South side of 116. Per local sources City of Morton never owned landfill at this location Our map uses TDH Lat/long. Site could actually be P-562 which is west of this location.
Source	1968 HEW
Site Name	Morton
Past Owner(s)	City of Morton, 201 E Wilson, Morton 79346
Curr Owner(s)	Unknown
Legal Description	Unknown
Current Land Use	Vacant Land
Lat-Long	N33 44.180, W102 41.870
POB	Center
Attachments	

Cochran County, Texas

Closed Landfill Unit: U-722

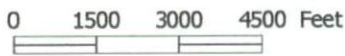

South Plains Association of Governments, 01/27/2001

Disclaimer: This map was prepared by the Southwest Texas State University Closed Landfill Inventory Team for the South Plains Association of Governments in response to provisions of Section 363.064, Texas Health and Safety Code. The closed landfill unit location and boundary indicated on this map are approximations only, based on the best available information. Specific land tract(s) have been identified within this approximate boundary in order to inform the current and prospective landowner(s) that a closed landfill unit(s) may exist on any or all of these tract(s); this map is not intended to influence the sale or purchase of real property. Accompanying this map is additional information on the subject closed landfill unit, land tract(s) and the assigned confidence level of the unit's location on this map.

Closed Landfill Inventory UNUM Site

COG Name	South Plains Association of Governements
COG Number	2
County Name	Cochran
County Number	40
UNUM Number	1869
Inspection Number	32305
Include?	Yes
Shape File	No
Location Confidence	Within 400 meters
Size	96
Comments	2.7 miles North & 0.5 mile East of SH 114 & FM 59, on North side of County Road
Source	TWC Inspection 7/13/93
Site Name	J K Griffith
Past Owner(s)	J. K. Griffith, Rt 2, Box 55, Morton 79346
Curr Owner(s)	J. K. Griffith per CAD staff (Lloyd Kern)
Legal Description	Unknown
Current Land Use	Open Pasture
Lat-Long	N33 47.790 W103 00.659
POB	Center
Attachments	Texas Water Commission Inspection Report

Cochran County, Texas

Closed Landfill Unit: U-32305

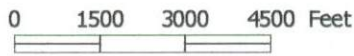
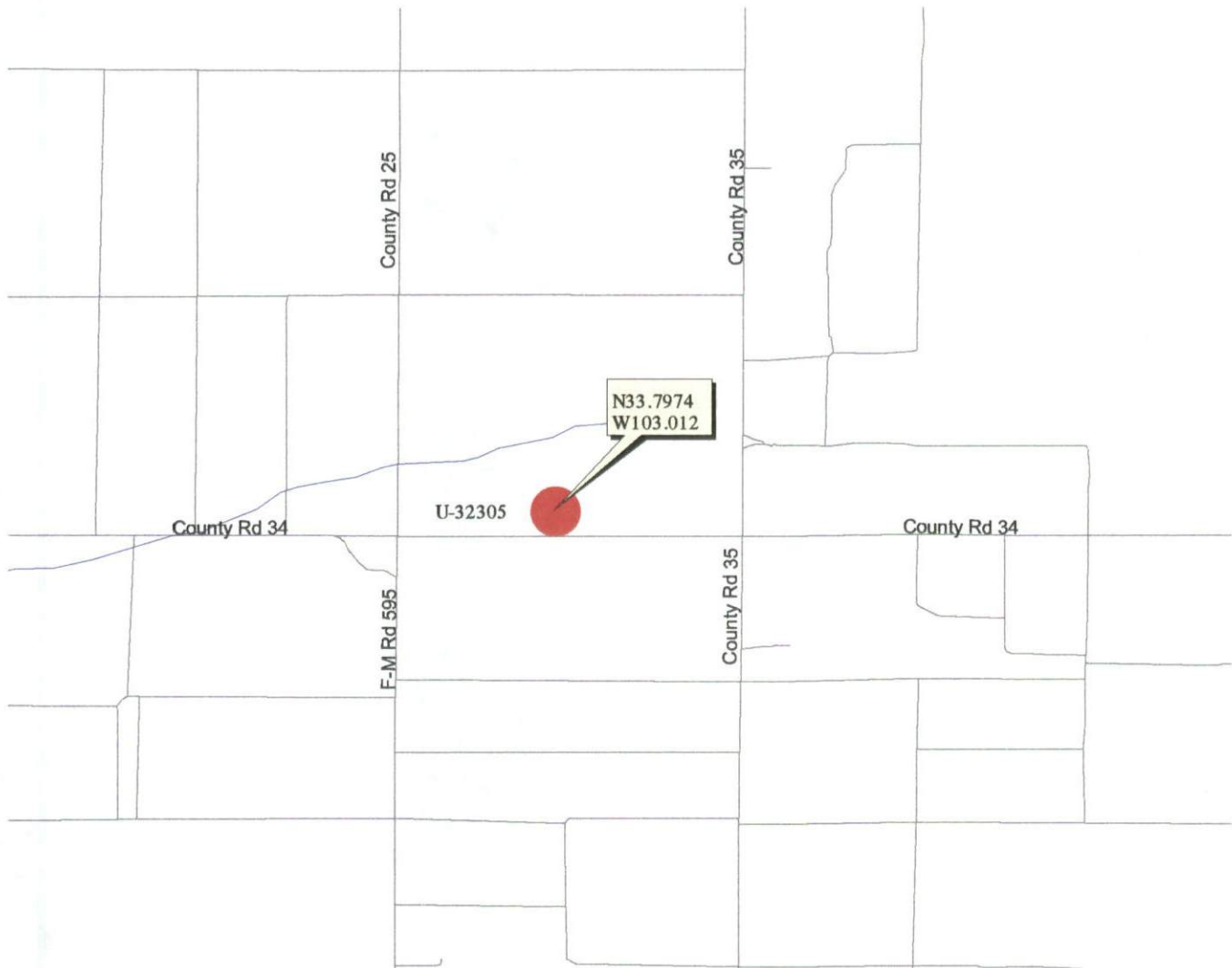

South Plains Association of Governments, 01/27/2001

Disclaimer: This map was prepared by the Southwest Texas State University Closed Landfill Inventory Team for the South Plains Association of Governments in response to provisions of Section 363.064, Texas Health and Safety Code. The closed landfill unit location and boundary indicated on this map are approximations only, based on the best available information. Specific land tract(s) have been identified within this approximate boundary in order to inform the current and prospective landowner(s) that a closed landfill unit(s) may exist on any or all of these tract(s); this map is not intended to influence the sale or purchase or real property. Accompanying this map is additional information on the subject closed landfill unit, land tract(s) and the assigned confidence level of the unit's location on this map.

**TEXAS WATER COMMISSION
MUNICIPAL SOLID WASTE DIVISION
INSPECTION REPORT
LANDFILL CLOSURE**

Permit #:
District No.: 2
County:
Pictures Taken? Yes / (No)

Inspection Date: 07/13/93
Time: 1:10-1:15 am / (pm)
Type: Unauthorized

Permittee/Business Name: J.K. Griffith
Responsible Person: J.K. Griffith Operator:
Primary Contact: Rt. 2, Box 55, Morton, TX 79346 Primary Contact:
Telephone #: 806/266-5962 Telephone #:
Person(s) Contacted: None
Person(s) Participating in Inspection: Alone
WC Representative(s): M.I. King, Jr., P.E.
Purpose of Inspection: Closed to Waste /Final Cover Complete /Post-Closure X /Final Closure /Special:
Next Inspection Date: 06/01/94 Date Last Inspection: 06/23/92
Describe, if this is a unit within an active site: N/A

***** INSPECTION RESULTS *****

Circle each item number below that was noted as a violation on last inspection.

- | | | | | | | | | |
|-------------------------------------|-------------------------------------|---|---------------|---|-------------------------------------|--------------------------|---|----------------------------------|
| Yes | No | * | | | Yes | No | * | |
| <input checked="" type="checkbox"/> | <input type="checkbox"/> | | A. | Site closed to unloading of waste | <input checked="" type="checkbox"/> | <input type="checkbox"/> | | K. Affidavit 330.152(c) |
| | | | | If yes, When? <u>09/91</u> | <input checked="" type="checkbox"/> | <input type="checkbox"/> | | L. Access Control |
| <input type="checkbox"/> | <input type="checkbox"/> | | <u>N/A</u> B. | Closure Schedule | <input type="checkbox"/> | <input type="checkbox"/> | | <u>N/A</u> M. Methane Monitoring |
| | | | | 330.152(a) | | | | |
| <input type="checkbox"/> | <input type="checkbox"/> | | <u>N/A</u> C. | Closure Plan Required | | | | |
| | | | | 330.152(b) | | | | |
| | | | | If Updated, When? <u> </u> | | | | |
| <input checked="" type="checkbox"/> | <input type="checkbox"/> | | D.1 | Has final cover work begun? | | | | |
| | <input type="checkbox"/> | | .2 | If No, waste compacted? | | | | |
| | <input type="checkbox"/> | | .3 | If No, intermediate cover? | | | | |
| <input checked="" type="checkbox"/> | <input type="checkbox"/> | | E.1 | Final cover timeliness | | | | |
| <input checked="" type="checkbox"/> | <input type="checkbox"/> | | .2 | Final cover thickness | | | | |
| <input checked="" type="checkbox"/> | <input type="checkbox"/> | | .3 | Final cover grades | | | | |
| <input checked="" type="checkbox"/> | <input type="checkbox"/> | | .4 | Final cover contours | | | | |
| <input checked="" type="checkbox"/> | <input type="checkbox"/> | | .5 | Vegetation started | | | | |
| <input checked="" type="checkbox"/> | <input type="checkbox"/> | | F. | Has final cover work been completed? | | | | |
| | | | | If Yes, When? <u>12/92</u> | | | | |
| <input checked="" type="checkbox"/> | <input type="checkbox"/> | | G. | Post-closure maintenance | | | | |
| | | | | 330.153 | | | | |
| | | | | Cover erosion | | | | |
| | | | | Depressions/settlement | | | | |
| | | | | Additional vegetation required | | | | |
| <input type="checkbox"/> | <input type="checkbox"/> | | <u>N/A</u> H. | Groundwater monitoring | | | | |
| | | | | 330.124 | | | | |
| <input checked="" type="checkbox"/> | <input type="checkbox"/> | | I. | Drainage control | | | | |
| | | | | 330.123(d) | | | | |
| <input type="checkbox"/> | <input checked="" type="checkbox"/> | | J. | Completion of post-closure maintenance period | | | | |

ORIGINAL RECORDS
 AUG - 2 93

Comment on each past violation and each answer other than a "Yes". Attach comment pages as necessary.

Comments: NA - Not Applicable, NO - Not Observed.

no subsidence or erosion. Good vegetative cover.

WC Representative's Signature: *M.I. King, Jr.* PE Date: 07/15/93
 Approved: *[Signature]* Date: 7-19-93

FIELD INSPECTIONS DIVISION
 JUN 21 93

Closed Landfill Inventory UNUM Site

COG Name	South Plains Association of Governements
COG Number	2
County Name	Cochran
County Number	40
UNUM Number	1870
Inspection Number	31615
Include?	Yes
Shape File	No
Location Confidence	Within 20 meters
Size	0.5
Comments	1000' East of 8th St & 3,121' North of FM1780, adjacent to Landfill & Sewer Plant.
Source	TNRCC Inspection 1/10/00
Site Name	City of Morton
Past Owner(s)	City of Morton, 201 E Wilson, Morton 79346
Curr Owner(s)	City of Morton per CAD (Lloyd Kern)
Legal Description	Lots 1-4 & 15-16, Block 24, E. B. Smith
Current Land Use	Vacant Land
Lat-Long	N33 44.203, W102 44.790
POB	Center
Attachments	TNRCC Inspection Report

Cochran County, Texas

Closed Landfill Unit: U-31615



South Plains Association of Governments, 01/25/2001

Disclaimer: This map was prepared by the Southwest Texas State University Closed Landfill Inventory Team for the South Plains Association of Governments in response to provisions of Section 363.064, Texas Health and Safety Code. The closed landfill unit location and boundary indicated on this map are approximations only, based on the best available information. Specific land tract(s) have been identified within this approximate boundary in order to inform the current and prospective landowner(s) that a closed landfill unit(s) may exist on any or all of these tract(s); this map is not intended to influence the sale or purchase or real property. Accompanying this map is additional information on the subject closed landfill unit, land tract(s) and the assigned confidence level of the unit's location on this map.

TEXAS NATURAL RESOURCE CONSERVATION COMMISSION
MSW INSPECTION REPORT
Inspection Type: FINAL POST CLOSURE - UNAUTHORIZED LANDFILL

Inspection Date:	01-10-2000	Time:	4:00 PM	Pictures Taken?	no	Copy To:	MSW Permits
MSW Site No.	31615	Type:	UNA	Region:	02	Facility County:	Cochran #040
Weather Conditions:	Clear, 55°F, Wind West 25-30 mph						
Entity Name / Permittee:	City of Morton						
Entity Representative:	Honorable Ronnie Wallace, Mayor						
Entity Address:	201 East Wilson Morton, TX 79346						
Entity Phone Number:	(806) 266-8850						
Operation Description:	Closed unauthorized waste disposal site						
Facility Contact:	Ms. Suzanne Bilbrey, City Manager, Mr. Bobby Warton, Landfill Operator						
Facility Address:	Approx 1000 feet E of 8th Street & 3121 feet N of FM-1780; Adjacent to and between City of Morton Waste Water Treatment Plant and Type IV-AE landfill MSW-2268						
Facility Phone Number:	(806) 266-8850						
Person(s) Contacted:	Ms. Suzanne Bilbrey; Mr. Bobby Warton; Mr. Jean Shotts, Morton City Attorney						
Person(s) Participating:	Mr. Bobby Warton						
TNRCC Inspector:	William I. King Jr.						
Purpose of Inspection:	Final Post Closure	Next Inspection:	None Scheduled	Last Inspection:	09-16-93		

INSPECTION REPORT ATTACHMENTS							
Landfill Forms		Landfill Forms Continued		Waste Tire Forms		Used Oil/Filter Forms	
Type 1-4 Landfill Checklist		Type 1-4 Closed Site Checklist		Tire Generator Checklist		UO/UOF Collection Center Ckl.	
Site Development Plan Checklist	X	Unauthorized Site Checklist		Tire Transporter Checklist		Used Oil Handler Checklist	
Site Operating Plan Checklist		Processor (Type 5) Checklist		Tire Storage Site Checklist		Used Oil Filter Handler Cklt.	
Record Keeping Checklist		Liquid Waste Processor Cklt.		Tire Facility Checklist		Miscellaneous Forms	
Landfill Gas Checklist		Medical Waste Checklist		Tire Transport. Facility Cklt.		Attachment Page(s)	
Landfill Gas Well Report		Compost Checklist		Land Reclamation Checklist		Photograph Page(s)	
Asbestos Checklist				PEL Inspection Checklist		Site Diagram	
Groundwater Checklist						Property Ownership Page	
Groundwater Well Report						X IOM	
Closure Checklist							

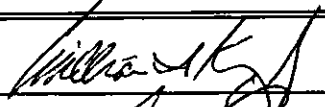
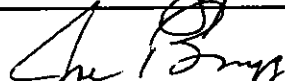
TNRCC Representative's Signature:		Date:	1-31-2000
Approved By:		Date:	2-1-2000

**TEXAS NATURAL RESOUR
MSW INS**

**SERVATION COMMISSION
REPORT**

MSW Permit No.	31615	Facility Name:	City of Morton UNA Site	County Name:	Cochran #040
Inspection Date:	01-10-2000	TNRCC Investigator:	William I. King Jr.		
GENERAL INSPECTION DESCRIPTION / COMMENTS					

The site was operated as an unauthorized waste disposal site in January, 1990. Site closure was completed in October, 1990. (An Affidavit to the Public was filed in Volume 193, Page 638 of the Cochran County Real Property Records. TDH letter to the City of Morton dated December 10, 1990 acknowledged closure of the site.

During the inspection it was noted that the site has remained closed to the acceptance of waste material. Waste material has remained covered. A vegetative cover has been established and the site is graded to drain. No subsidence or cover erosion was noted during the inspection.

Recommend the site be released form post closure maintenance requirements and the file for the site be closed.

Closed Landfill Inventory UNUM Site

COG Name	South Plains Association of Governements
COG Number	2
County Name	Cochran
County Number	40
UNUM Number	1871
Inspection Number	31614
Include?	Yes
Shape File	Yes
Location Confidence	Within 20 meters
Size	0.75
Comments	2 blocks West of South Main on South side of West Cleveland. Have metes/bounds legal description.
Source	Affidavit 195/85, TNRCC Inspection I9/16/93
Site Name	H W Hendon
Past Owner(s)	H. W. Hendon, 505 W. Harding, Morton, 79346
Curr Owner(s)	H.W. Hendon per CAD staff (Lloyd Kern) H.W. <i>Cherolyne Hendon</i>
Legal Description	Tract 8, C.C. Slaughter, Block 1
Current Land Use	Vacant Lot
Lat-Long	N33 42.696, W102 45.842
POB	SWC
Attachments	Affidavit MapDraw TNRCC Inspection Report

Cochran County, Texas

Closed Landfill Unit: U-31614

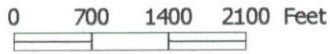
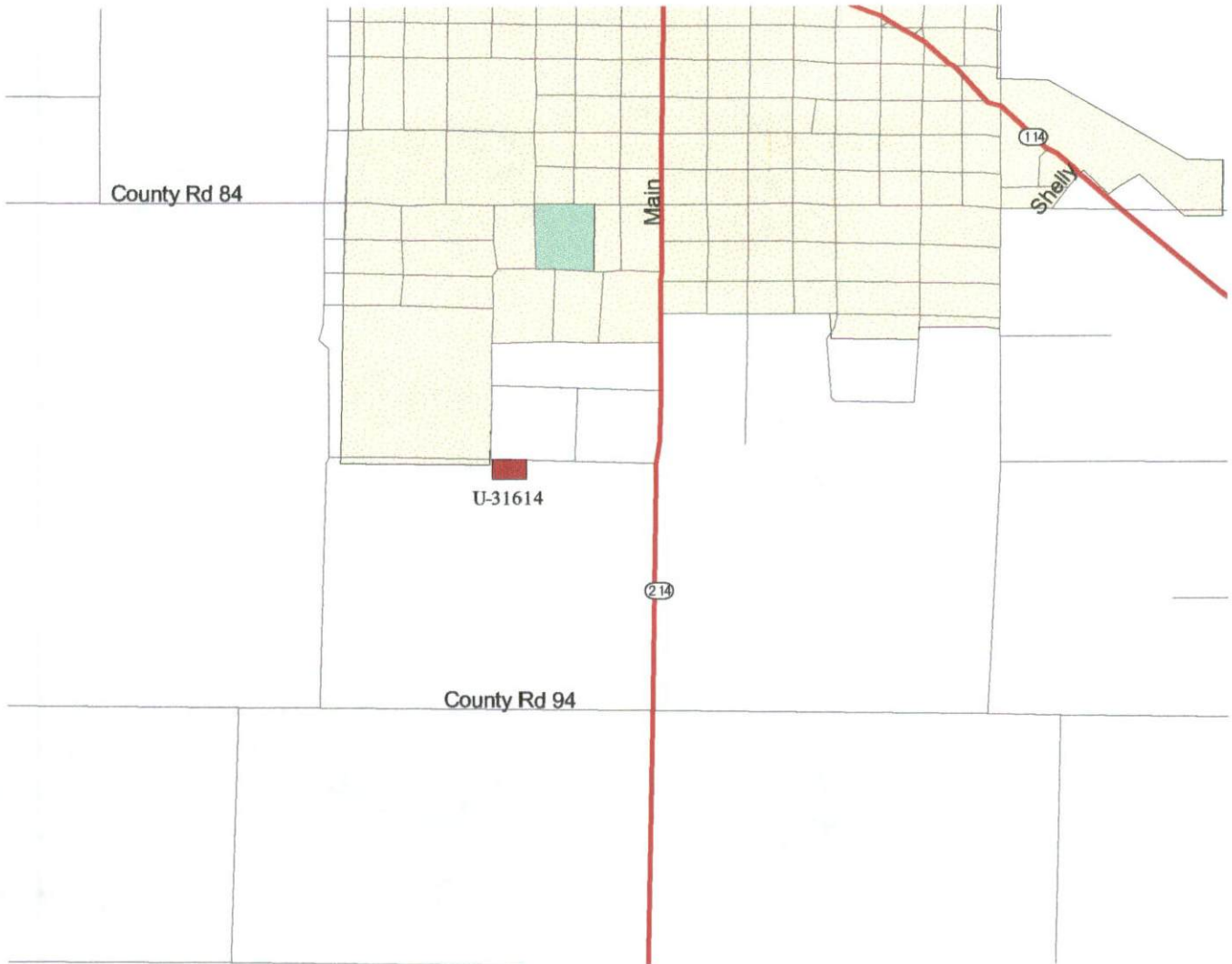

South Plains Association of Governments, 01/25/2001

Disclaimer: This map was prepared by the Southwest Texas State University Closed Landfill Inventory Team for the South Plains Association of Governments in response to provisions of Section 363.064, Texas Health and Safety Code. The closed landfill unit location and boundary indicated on this map are approximations only, based on the best available information. Specific land tract(s) have been identified within this approximate boundary in order to inform the current and prospective landowner(s) that a closed landfill unit(s) may exist on any or all of these tract(s); this map is not intended to influence the sale or purchase or real property. Accompanying this map is additional information on the subject closed landfill unit, land tract(s) and the assigned confidence level of the unit's location on this map.

#1871

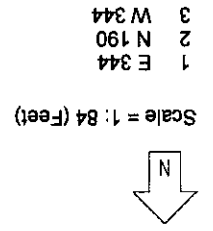
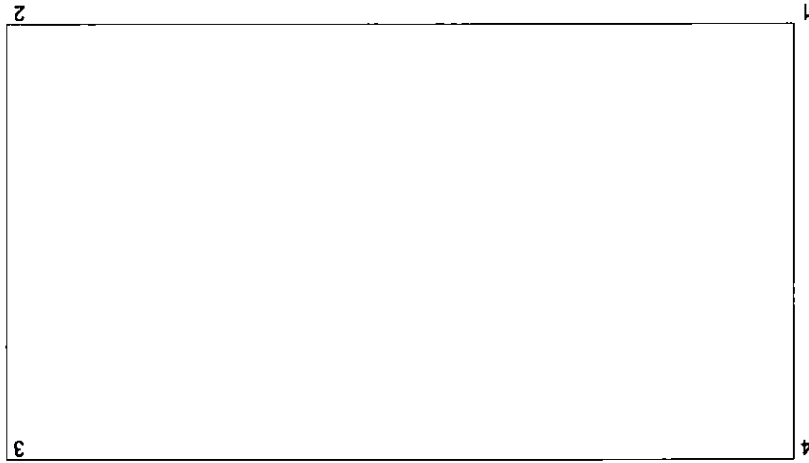

4 S 190

1 E 344
2 N 190
3 W 344

31614 ~~31614~~
EVL 195 PAGE 85 Cochran

9528

STATE OF TEXAS

COUNTY OF COCHRAN

AFFIDAVIT TO THE PUBLIC

Before me, the undersigned authority, on this day personally appeared H. W. HENDON who, after being by me duly sworn, upon oath states that he is the record owner of that certain tract or parcel of land lying and being situated in Cochran County, Texas, and being more particularly described as follows:

Part of the South thirty (30) acres of the North fifty (50) acres of the East One-Half (E 1/2) of Tract Eight (8), C. C. Slaughter Block One (1), Cochran County, Texas, described as follows:

Beginning at the Southwest corner of said South 30 acres of the North 50 acres of said East One-Half (E 1/2) Tract No. Eight (8);

THENCE East along the South line of said 30 acre tract a distance of 3/4 feet to a point in the South line of said 30 acre tract for the Southeast corner of the tract herein conveyed;

THENCE North parallel with the West line of said 30 acre tract a distance of 190 feet to a point, the Northeast corner of the tract herein conveyed;

THENCE West parallel with the South line of said 30 acre tract a distance of 346 feet to a point in the West line of said East One-Half (E 1/2) of Tract No. Eight (8), for the Northwest corner of the tract herein conveyed;

THENCE South along the West line of said East One-Half (E 1/2) of Tract No. Eight (8), 190 feet to the place of beginning and the Southwest corner of said 30 acre tract of said East One-Half (E 1/2) of Tract No. Eight (8).

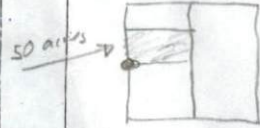

The undersigned further states that from the year 1987 to the year 1990 there was operated on the aforesaid tract of land a Solid Waste Disposal Site. Specifically, such operation was conducted on that portion of the aforesaid tract described as the East One-Half (E 1/2) of the above described tract.

Further, the undersigned, H. W. Hendon was the operator of such Solid Waste Disposal Site.

Notice is hereby provided to any future owner or user of the site to consult with the Texas Department of Health Prior to planning or initiating any activity involving the disturbance of the land-fill cover or monitoring system.

WITNESS MY HAND on the the 11th day of February, 1991.

H. W. Hendon
Owner-Operator

SWORN TO AND SUBSCRIBED BEFORE ME on the the 11th day of February, 1991.



Linda Hujak-Bee
Notary Public, Cochran County, Texas

File No: 9528
Affidavit to the Public
H.W. Hendon To The Public
Filed For Record: February 11, 1991 at 11:40 A.M.
Rita Tyson, County Clerk, Cochran County, Texas

TEXAS NATURAL RESOURCE CONSERVATION COMMISSION
MUNICIPAL SOLID WASTE DIVISION
INSPECTION REPORT
UNAUTHORIZED LANDFILL

Site #: ~~MSW23161473~~
Region No.: 2
County: Cochran
Pictures Taken? Yes/(No)

Time: 12:45 am/(pm)
Inspection Date: 09/16/93

Site Location: 2 blocks W of S Main St on S side of W Cleveland

Landowner(s): H. W. Hendon
Mailing Address: 505 W Harding

Operator: _____
Mailing Address: _____

Morton, TX 79346
Telephone #: (806) 266-5656

Telephone #: _____

Person(s) Contacted: None

Person(s) Participating in Inspection: Alone

TNRCC Representative(s): William I. King Jr., P.E.

Purpose of Inspection: Routine ___ / Followup ___ / Compliance ___ / Complaint ___ / Closure ___ / Post-Closure X

Special: _____

Describe Operation: Unauthorized waste disposal in a borrow pit.

Next Inspection Date: 09/01/94 Date Last Inspection: 10/15/92

Weather Conditions: Clear, 75°F, Wind SW 10-15 mph

***** INSPECTION RESULTS*****

Circle each item number below that was noted as a violation on last inspection.

YES NO *

A. ___ X ___ IS SITE OPERATED WITH LANDOWNER'S CONSENT?

B. ___ X ___ IS THERE ANY INDICATION OF TIPPING FEES?

C. Describe solid waste being deposited (estimate amount): Construction demolition debris buried on site. Inert fill still being added to site.

D. Acres filled: _____ Approximate dimensions of active disposal area: 100' X 200'

E. Describe the general topography and soil conditions at the site (gravel/sand pit, rock quarry, on the ground, etc.) Flat sandy soil with agricultural and residential areas surrounding.

F. Describe observed conditions such as locations of homes, water wells, etc., in the vicinity of the site: Houses to E and N, industrial building to W, agricultural land to S.

G. What kind of equipment is on site? None

H. List known transporters (including mailing address) on separate sheet.

I. Make a simple line drawing on separate sheet of paper keyed to photographs, showing the area of waste deposited, boundaries of site, nearby roads, streams, houses, water wells, etc.

TNRCC Representative's Signature *William I. King Jr.* Date 09/27/93

Approved *[Signature]* Date 10-1-93

Comments: No new waste on site, access restricted, no cover erosion, horses grazing on site. PCM thru 2/96.